

Microvette® 100/200

User Guide

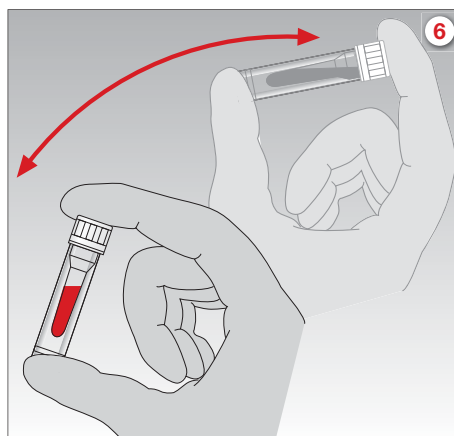
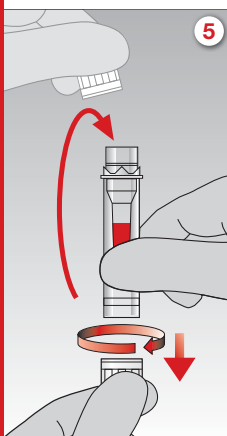
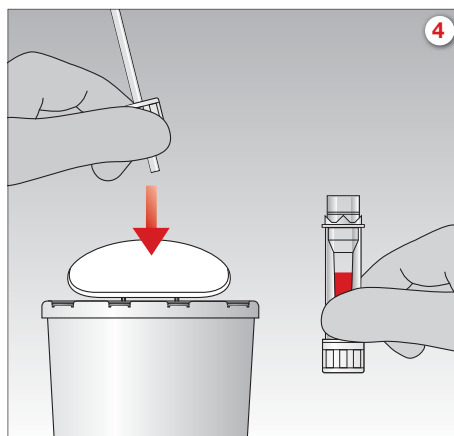
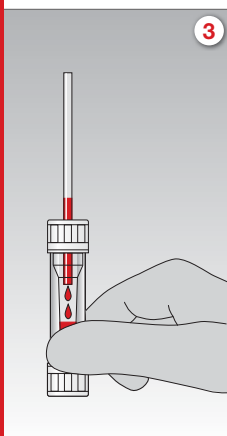
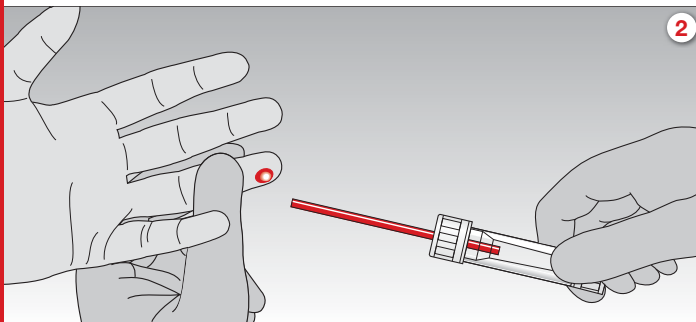
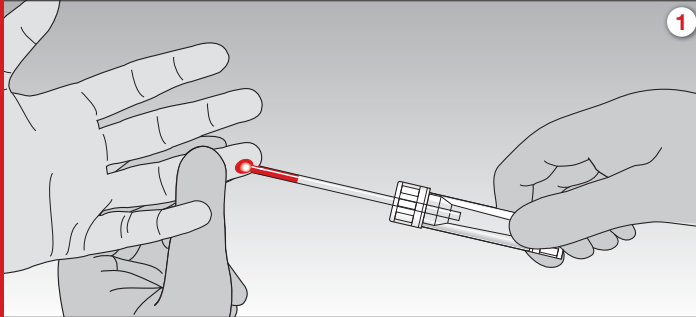

1. Collect blood with the assembled End-to-End 100 µl or 200 µl capillary. For collection, best results are achieved if the Microvette® is held in horizontal or slightly inclined position. During blood collection, hold the capillary 3 to 5 mm away from the puncture site.
2. Collection is complete when the End-to-End capillary is entirely filled with blood.
3. Hold the tube upright to allow the blood to flow from the capillary into the Microvette®.
4. Turn the cap to remove and discard the preassembled capillary as one unit.
5. Remove the cap from the base and seal the Microvette® ('click' position).
6. Mix sample thoroughly by inverting the Microvette®.

All patient blood specimens should be treated with standard precautions.

Wear gloves!